

PS2 KVM



Options

- DC power options : 12V / 24V / 48V / 125V

Benefits

- DB-15 KVM with 8 ports in 1U
- Local console & KVM ports support resolution up to 1920 x 1200
- Multi-platform for PC, server & Blade Server
- Port switching via OSD, front button & keyboard hotkeys
- Multi lingual OSD menu
- Hot pluggable, no software or drivers required
- Cascade levels up to 8 KVM switches



Basic Models - local console x 1

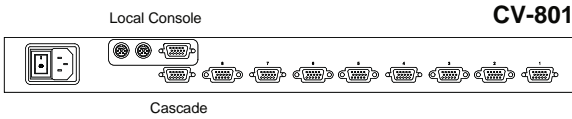

KVM Port	
Port # :	8
Connector :	DB-15
Connectivity :	VGA + PS2 KB / MS 3-in-1 KVM cable (6 / 10 / 15 / 33 feet)
Resolution :	16:10 - max. 1920 x 1200 / 4:3 - max. 1600 x 1200
Local Console	
Graphic Connector :	1 x DB-15 VGA
Input device :	2 x PS2 for keyboard & mouse
Resolution :	16:10 - max. 1920 x 1200 / 4:3 - max. 1600 x 1200

Local console & KVM port connection

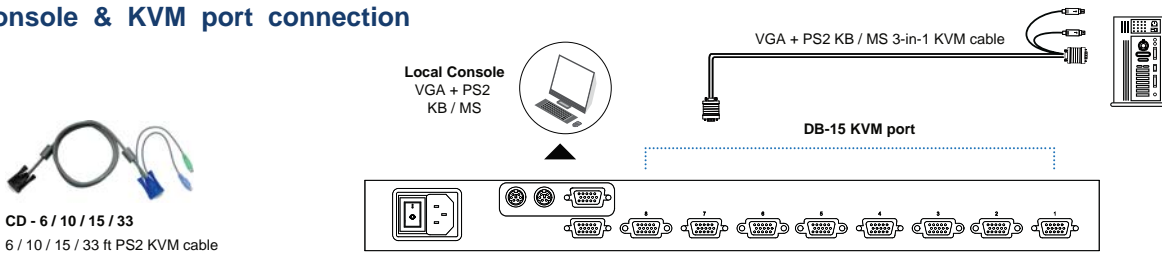

KVM Cascade

- 8-level cascade up to 64 servers
- KVM cascade via CBC-6
- 1st level KVM takes all control of slave KVMs

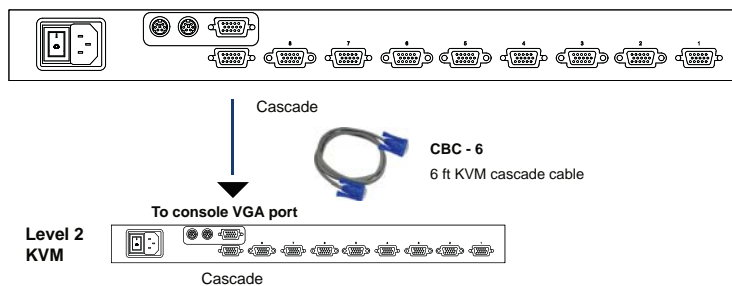

Management

Port switching	OSD, front button & keyboard hotkeys
Expansion	8-level cascade up to 64 servers

Power

Input	Auto-sensing 100 to 240VAC, 50 / 60Hz
Consumption	Max. 12W

Compatibility

Hardware	HP / IBM / Dell PC, Server and Blade Server
OS support	Windows / Linux / Unix / Mac OS

Compliance

Safety	FCC & CE certified
Environment	RoHS2 & REACH compliant

Environment

Operating temp.	0 to 55°C degree
Storage temp.	-20 to 60°C degree
Operating humidity	20~90%, non-condensing
Storage humidity	5 ~90%, non-condensing
Operating altitude	16,000 ft
Non-operating altitude	40,000 ft
Shock	10G acceleration (11ms duration)
Vibration	10~300Hz 0.5G RMS random vibration

Physical

Product (W x D x H)	443 x 171 x 44 mm	
	17.4 x 6.7 x 1.73 inch	
Packing (W x D x H)	500 x 400 x 90 mm	
	19.7 x 15.7 x 3.5 inch	
Weight	Net	3 kg / 6.6 lb
	Gross	5 kg / 11 lb
Chassis color	Dark	
Chassis materials	Steel	