

CAT5 VGA/DATA Transmitter

Installation Guide



International HQ

Jerusalem, Israel
Tel: + 972 2 535 9666
minicom@minicom.com

North American HQ

Linden, New Jersey
Tel: + 1 908 4862100
info.usa@minicom.com

German Europe

Zurich, Switzerland
Tel: + 41 1 455 6220
info.german@minicom.com

Italy

Rome
Tel: + 39 06 8209 7902
info.italy@minicom.com

www.minicom.com

Customer support - support@minicom.com

CAT5 VGA/DATA TRANSMITTER

1. What is the CAT5 VGA/DATA Transmitter?

The CAT5 VGA/DATA Transmitter (VDT) from Minicom transmits high-resolution computer video (VGA) and RS232 signals along a shielded CAT5 cable. (The RS232 signals are Transmit and Receive only).

This Installation Guide illustrates the VDT and explains how to install it.

2. Features

- Transmits along the shielded CAT5 cable up to a distance of 110m away
- Controls a projector/plasma screen or any RS232 device connected to the Remote unit
- Extends your VGA screen up to 110m
- Built-in cables
- Local screen connects to the Local unit
- 2 LEDs on each unit. One indicates the power supply is connected, the other indicates that a transmission is in progress

3. Connecting the VDT system

The figure below illustrates the Local and Remote VDT unit connections.

Connect a Power supply to each unit.

Once connected the VDT system is ready to transmit VGA and RS232 signals.

DB9 pin connection

- Pin 2 - Transmit
- Pin 3 - Receive
- Pin 5 - Ground

Picture adjuster

Use a screwdriver to turn the picture adjuster on the Remote unit, to get a clear projected image.

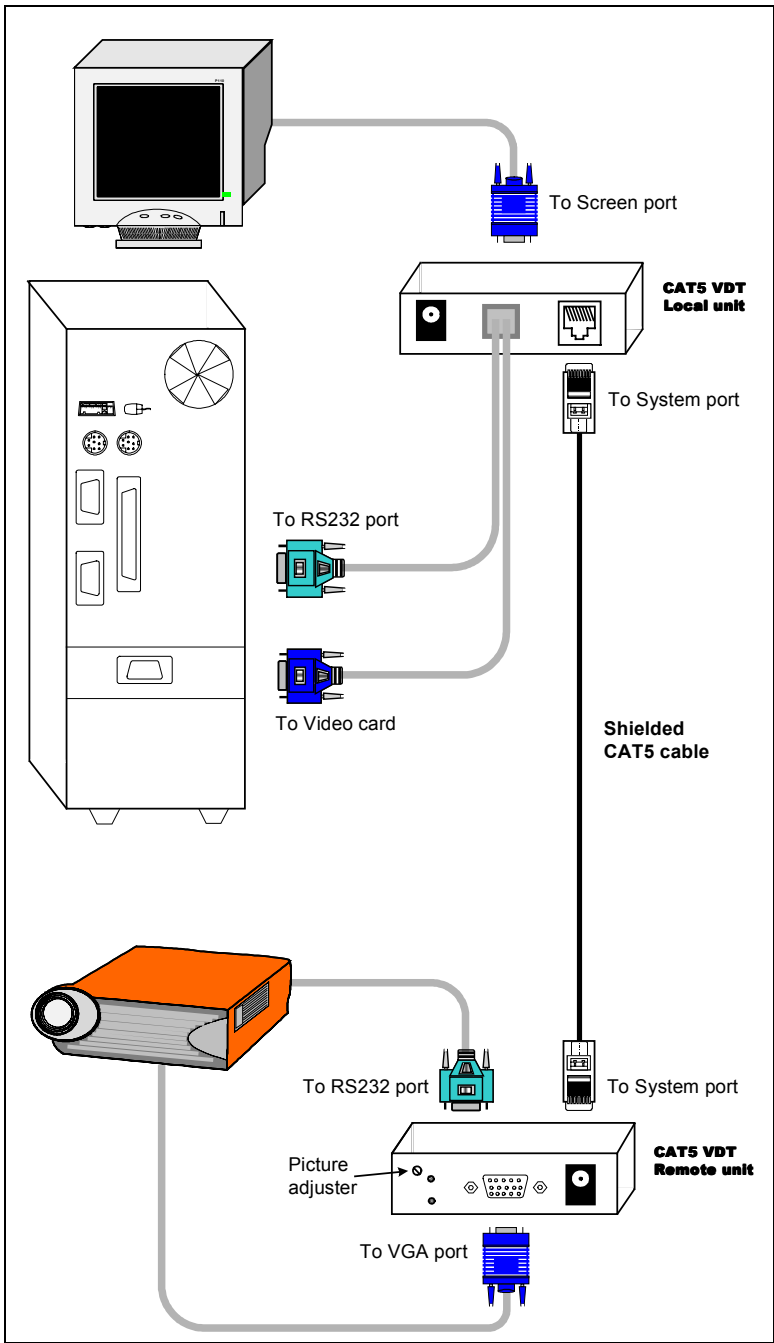

4. Technical specifications

System

| | |
|----------------------------|--------------------------------------|
| Resolution | Up to 1600 x 1200 @ 75Hz |
| System cable | Shielded CAT 5 FTP cable |
| Maximum distance | 110m/360ft |
| RS232 connection | Bi-directional Transmit/Receive only |
| System order number | 0VS23003 |
| Shipping weight | 880g |
| Package dimensions | 335 x 150 x 110 mm |
| Warranty | 3 years |
| Operating temp. | Up to 50°C |
| Storage temp. | -40°C to 70°C |

Local unit

| | |
|----------------------------|---|
| Cables / Connectors | VGA – HDD15 RS232 – DB9 Local Screen – HDD15 System Out – RJ45 |
| Dimensions | 63 x 77.5 x 23 mm |
| Weight | 175g |
| Power consumption | 6VDC, 2A, from AC/DC adapter |

Remote unit

| | |
|--------------------------|--|
| Connectors | VGA Out – HDD15 RS232 – DB9 System In – RJ45 |
| Dimensions | 63 x 77.5 x 23 mm |
| Weight | 155g |
| Power consumption | 6VDC, 2A, from AC/DC adapter |